

## Introduction of lubricated tappet and boot assemblies (as supplied in new Tappet and Boot Kits for Knorr-Bremse Disc Brakes)

As part of a continuous development process, Knorr-Bremse has introduced tappet and boot assemblies with long-life grease and a transportation cap. They are replacing the current not lubricated assemblies. This change affects kits used for Knorr-Bremse brakes in series: SN5; SN6; SN7; SK7; SL7 and SM7.

**The lubricated tappet and boot assembly is now available for the SN5 series!**

### What's new?

The new tappet and boot assemblies replace the current non-lubricated version although any stocks of the latter may be used up without concern.



The original SN5 non-lubricated version K001929 is replaced by the lubricated version K097826K50. The part numbers K010603 and K046523K50 will remain the same as they are already lubricated.

Brake Type	Replaced part number	Part number for kit
SN5	K001929	K097826K50
SN6/7, SK7		K010603
SL7/SM7		K046523K50

The information contained herein is subject to alteration without notice and therefore may not be the latest release. Please check our website [www.knorr-bremseCVS.com](http://www.knorr-bremseCVS.com) for the latest update or contact your local Knorr-Bremse representative. The figurative mark "K" and the trademarks KNORR and KNORR-BREMSE are registered in the name of Knorr-Bremse AG. Additional terms and conditions apply; please refer to our website [www.knorr-bremseCVS.com](http://www.knorr-bremseCVS.com) for full Disclaimer.

Note: If service work is carried out on a vehicle based on information provided herein, it is the responsibility of the workshop to ensure the vehicle is fully tested and in full functional order before the vehicle is returned into service. Knorr-Bremse accepts no liability for problems caused as a result of appropriate tests not being carried out.

Copyright © Knorr-Bremse AG - all rights reserved, including industrial property rights applications. Knorr-Bremse AG retains any power of disposal, such as for copying and transferring.

Knorr-Bremse Systeme für Nutzfahrzeuge GmbH . Georg-Knorr-Strasse 4 . 12681 Berlin . Germany . Tel: +49 1802 237 637 . Fax: +49 30 9392-3426 . [www.Knorr-Bremse.com](http://www.Knorr-Bremse.com) . [www.Knorr-BremseCVS.com](http://www.Knorr-BremseCVS.com)

### Installation guideline

Before fitting the new tappet and boot assembly, the transportation cap should be removed and disposed of as controlled waste.

The lubricant must not be removed or spread over the product  
Additional lubricant must not be applied

This technical change has no impact on the actual mounting process or the required service tools.

For further information on the fitting procedure, please refer to the service manual for the relevant Knorr-Bremse air disc brake and specifications of the vehicle manufacturers. You will find Knorr-Bremse service manuals on our website [www.knorr-bremseCVS.com](http://www.knorr-bremseCVS.com)

**Please note, the following highlighted amendments to the current service manuals:**

### 7.3 Fitting of Tappet and Boot Assemblies (13)

With caliper installed on the vehicle:

7.3.1. To fit the tappet and boot assemblies (13), use tool (E<sup>1</sup>) (see Fig.).

7.3.2. Wind back fully the threaded tube (16) until it stops (see Section 6.1.4).

**Note: Make sure that the sealing areas (X) of the boot and the caliper are clean and lubricant free.**

7.3.3. Fit new tappet bushes (161) onto the spigots of the threaded tubes (16), then follow with the tappet and boot assemblies (13) pushing them into position (see Fig.).

7.3.4. Position tool (E<sup>1</sup>), note at this point (T56) is not required, so that (T28) touches the brake disc. Using a spanner, screw out (T03) to press tappet and boot assembly (13) into place.

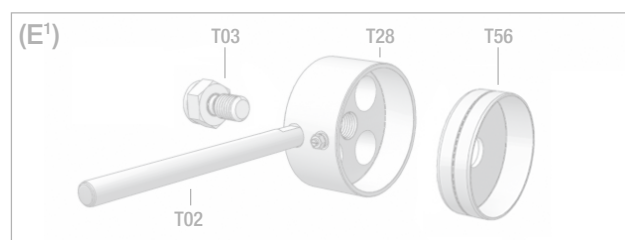

7.3.1 - Press-in tool (E<sup>1</sup>)

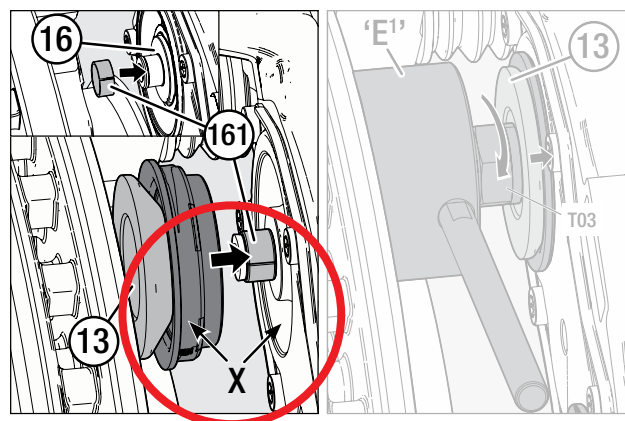

7.3.3 - Fit new tappet bush /  
tappet with boot assembly to the  
spigot

7.3.4 - Press in the tappet using  
tool (E<sup>1</sup>) (without T56)

#### Disclaimer:

The information contained herein is intended for the exclusive use of trained persons within the commercial vehicle industry, and must not be passed on to any third party. All recommendations regarding products and their servicing or usage are with reference to Knorr-Bremse products and should not be considered applicable to products from other manufacturers. This information does not purport to be all-inclusive and no responsibility is assumed as a result of its use. We cannot accept any liability nor offer any guarantee regarding data accuracy, completeness or timeliness. The information does not represent any guarantee or ensured characteristics of the Products or Systems described.

No liability can be accepted based on the information, its use, recommendations or advice provided. In no event may we be held liable for any damage or loss except in the case of wilful intent or gross negligence on our part, or if any mandatory legal provisions apply.

This disclaimer is an English translation of a German text, which should be referred to for all legal purposes. Any legal disputes arising from the use of this information shall be subject to German law.

The information contained herein is subject to alteration without notice and therefore may not be the latest release. Please check our website [www.knorr-bremseCVS.com](http://www.knorr-bremseCVS.com) for the latest update or contact your local Knorr-Bremse representative. The figurative mark "K" and the trademarks KNORR and KNORR-BREMSE are registered in the name of Knorr-Bremse AG. Additional terms and conditions apply; please refer to our website [www.knorr-bremseCVS.com](http://www.knorr-bremseCVS.com) for full Disclaimer.

Note: If service work is carried out on a vehicle based on information provided herein, it is the responsibility of the workshop to ensure the vehicle is fully tested and in full functional order before the vehicle is returned into service. Knorr-Bremse accepts no liability for problems caused as a result of appropriate tests not being carried out.

Copyright © Knorr-Bremse AG - all rights reserved, including industrial property rights applications. Knorr-Bremse AG retains any power of disposal, such as for copying and transferring.

Knorr-Bremse Systeme für Nutzfahrzeuge GmbH · Georg-Knorr-Strasse 4 · 12681 Berlin · Germany · Tel: +49 1802 237 637 · Fax: +49 30 9392-3426 · [www.Knorr-Bremse.com](http://www.Knorr-Bremse.com) · [www.Knorr-BremseCVS.com](http://www.Knorr-BremseCVS.com)