

Einbaulage stehend (wie gezeichnet)
 max. 60° geneigt
 Installation position upright (as drawn)
 tilt to any side max. 60°

Betriebsdruck max.: 20 bar
 Operating pressure max.: 20 bar

Staudruck bei 7 bar und 400 NI/min: < 0.3 bar
 Dynamic pressure at 7 bar and 400 NI/min: < 0.3 bar

Schuetzelfestigkeit: 10g
 Resistance against vibrations: 10g

Thermischer Anwendungsbereich:
 Funktionssicherheit -30°C...+65°C
 Temperaturvertraeglichkeit -40°C...+80°C

Permissible temperature range:
 Functional reliability -30°C...+65°C
 Temperature compatibility -40°C...+80°C

Taupunktabsenkung: min. 30°C gemessen am Knorr-Bremse
 Referenzsystem (Taupunkt der angesaugten Luft 11°C)
 Dew point lowering: min. 30°C measured at Knorr-Bremse
 reference system (dew point of the air intake 11°C)

Korrosionsbestaendigkeit nach DIN EN ISO 9227-NSS: 144 h
 Corrosion resistance according to DIN EN ISO 9227-NSS: 144 h

Text: RAL 9003 signalweiss
 Text: RAL 9003 signal white

*Gehaeuse: Oberflaeche RAL 9004 signalschwarz
 *Housing: Surface RAL 9004 signal black

Trockenmittel: Silicagel (66)
 Desiccant:

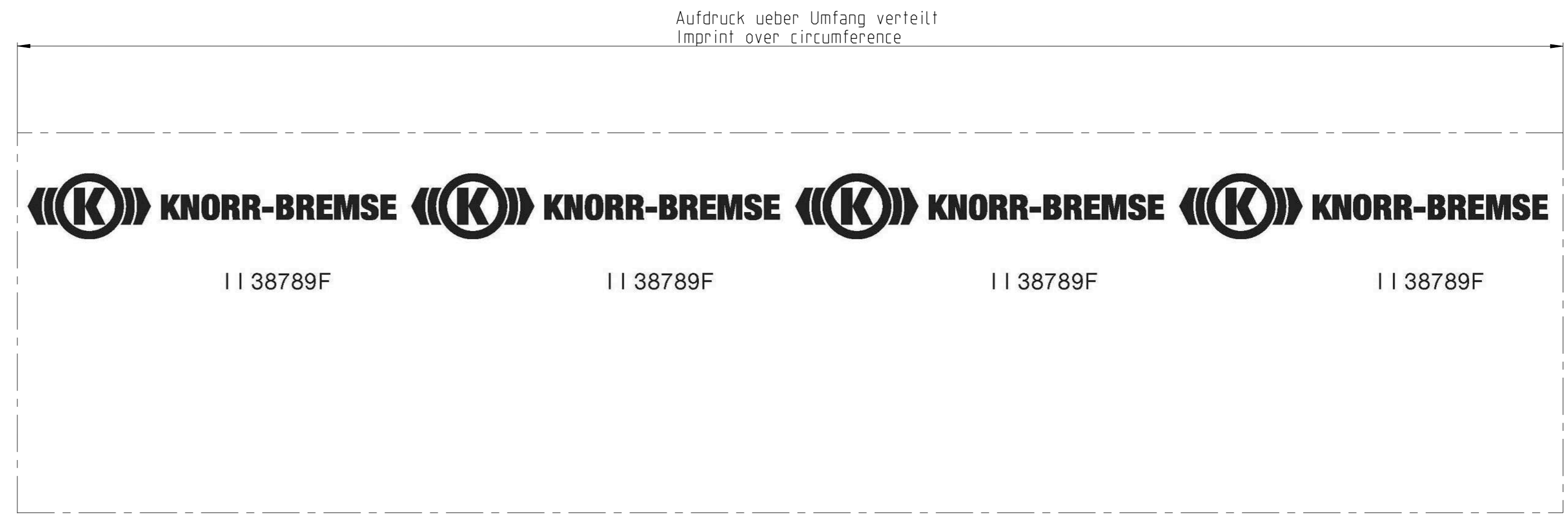
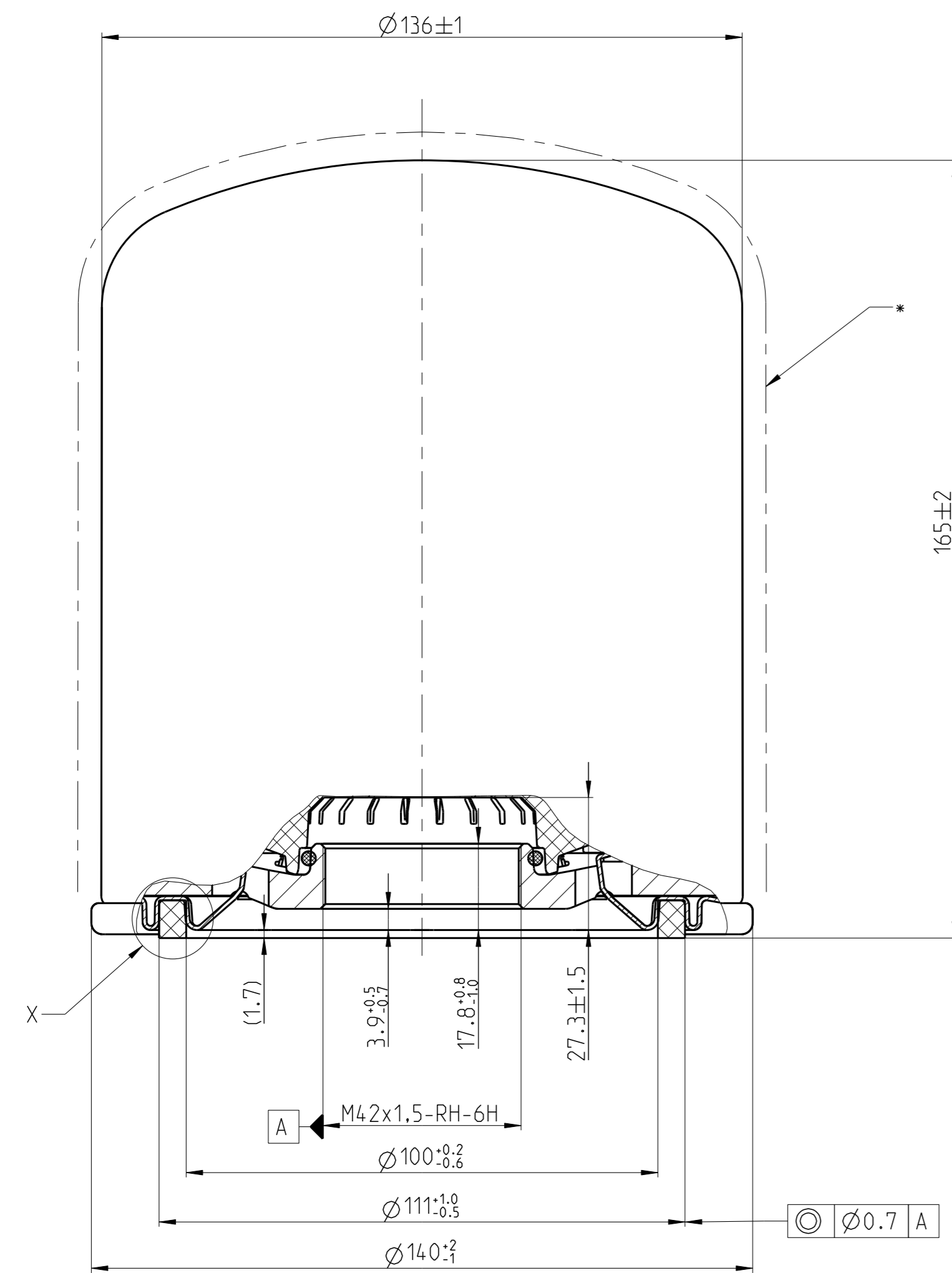
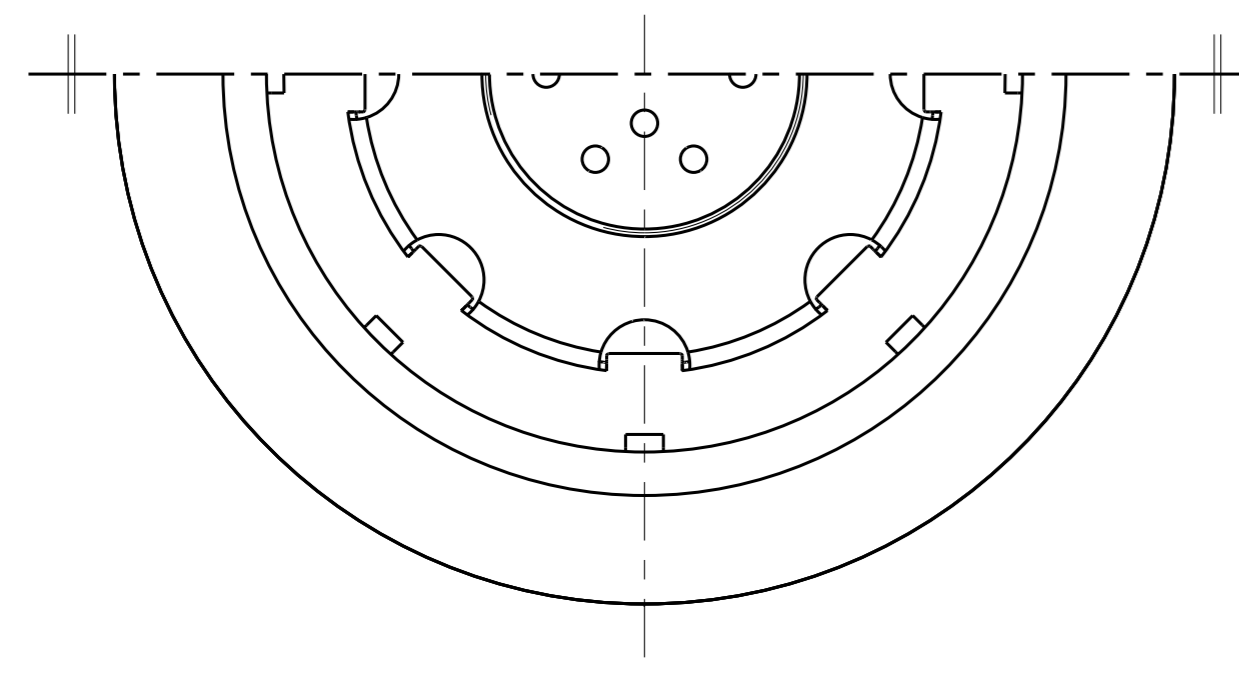

Aufdruck ueber Umfang verteilt
 Imprint over circumference

X 2:1
 Dichtring demontiert
 Sealing ring disassembled

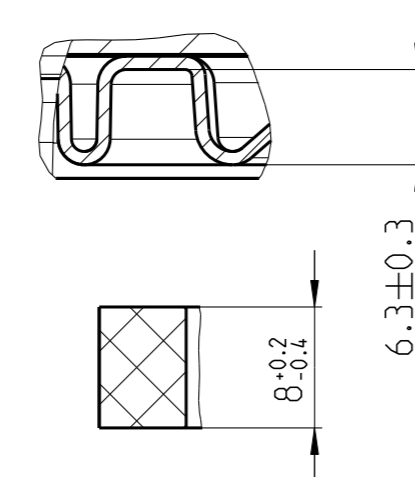

Zubehoer/Accessory
 O-Ring/O-seal

Disclaimer
 The information contained herein is intended for the exclusive use of trained persons within the commercial vehicle industry. This product or component may be suitable only for the specific application set forth herein. Statements regarding the suitability of products for certain types of applications are based on Knorr-Bremse understanding of typical requirements. Such statements, however, are not binding statements about the suitability of products for any different application. It is at all times the user's responsibility to validate the suitability of a particular product for use in a different application than contained herein. This information does not purport to be all-inclusive and no responsibility is assumed as a result of its use. In no event may we be held liable for any damage or loss except in the case of willful intent or gross negligence on our part, or if any mandatory legal provisions apply.

005 TSK227516.CR027971	15.08.2013	Hoernagl			
004 TSK012497	2008/04/23	Kral			
003 ECR001841		Jano			
002 Y002009 - Bestell Nummer Änd.		Poly			
001 mit Textaufdruck ersetzt Etikett		HBT			
006 TSK0489689.CR0042500	16.12.2016	Hoernagl			
Rev.	Revision Reference	Date	Name		
1138789F	ISO 128-30	Special Characteristics:	0 [S/C]	Surface Treatment:	Length Unit: mm Scale: 1:1
or	First Angle Proj.	Tolerancing Principle ISO 14305	0 [C/V]	Weight: 2.6	kg
See Table 1	General Tolerances ISO 2768 - m/Made from:				
CAD Model MD16236_HIGH_PRESSURE_CARTRIDGE	Corners ISO 13715	Desiccant Cartridge			
KNORR-BREMSE	CAD Sys.: PRO/ENGINEER	Trockenmittelpatrone			
Systeme für Nutzfahrzeuge GmbH	Responsible Dept./Team MDT2				
	Drawn 2013/10/18 Hoernagl				
	Release Process Documentation in EDM, Level and Status Information in Watermark.	Drawing Number	D484830172A		Drw-Rev: 006
		Doc-Type: ID	Language: 52	Sheet 1 of 1	