

EAC 2.5 (Electronic Air Control) – New Service Concept

EAC Service Parts for Volvo/Renault applications

With over 12 years of field experience and a field population over one million EAC, we ensure the highest safety standards, reliability and optimal service. In order to continuously ensure the highest quality and best service for the servicing of the EAC 2.5 system a new range of service parts is now available for the Independent Aftermarket.

EAC2.5

The EAC provides the intelligent air management of the vehicle pneumatic system. For the first time an electronically controlled parking brake is integrated into the EAC.

The EAC ensures the following main functions:

- EAC controls the filling of the brake and auxiliary circuits
- Fuel saving by intelligent compressor control
- Due to smart control no trailer or parking brake reservoir is required
- Cartridge maintenance prediction
- Electronic Parking Brake can be gradually applied and released
- Through integration of park brake relay valve into EAC2.5 fewer pipes exist in the system => reduced risk of pipe defects and leakage

The following service parts are now available:

- Cartridge Insert and Sieve Kit (including locking screws)
- Cartridge Housing, Insert and Sieve Kit (including Cartridge Housing in Knorr-Bremse brand, Cartridge Insert, Sieve and locking screws)
- Bayonet Ring (including locking screws), Silencer, Relay Valve, Exhaust Connector and Safety Valve Kit

Benefits at a glance

- Original equipment quality - no compromise in energy saving functions and lowest possible downtime
- Service strategy includes NEO diagnostics and guided troubleshooting
- Genuine Knorr-Bremse approved parts - no compromises in quality
- Best-in-class air drying with the Knorr-Bremse OSC (Oil Separator Cartridge)
- Bayonet cartridge to guarantee optimal OE quality
- All parts for optimal service included for easy plug 'n' play

The following pages contain an overview and additional information of Aftermarket Products for the EAC2.5.



EAC2.5

Please note: for more information about servicing of the EAC2.5 see Documents No. Y149587, Y149588 and Y162789, available from the Document Download section of our website: www.Knorr-BremseCVS.com.

Aftermarket Products for EAC2.5

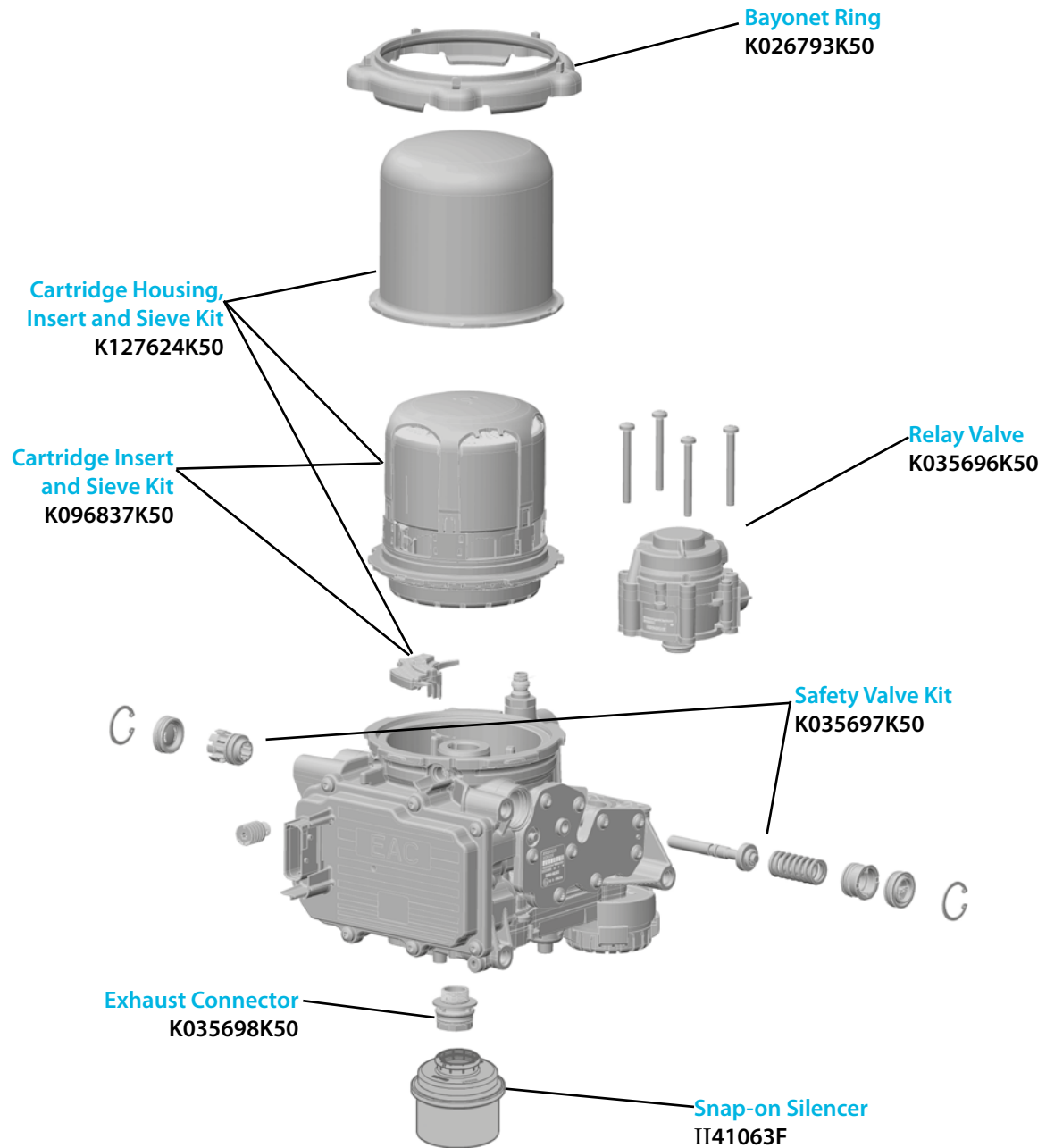

Aftermarket Products for EAC2.5 (contd.)

Vehicle Manufacturer	Vehicle Application	Vehicle Manufacturer Part No.	Knorr-Bremse Part No.		Old Knorr-Bremse IAM Part No. (incl. Cartridge)	New Knorr-Bremse IAM Part No. (incl. Cartridge)
Renault	K, C & T Range - Euro 6	7421902425	K070286N06	1), 2)	K107482N50	K148329N50
		7421944093	K096432N06	1), 2)		
		7422169411	K096434N06	1), 2)		
		7422054429	K093078N06	1), 2)		
		7422242664	K099935N06	1), 2)		
		7422358799	K107483N06	1), 2)		
		7422820096	K132981N06	1), 2)		
Volvo	FH / FM Truck - Euro 6		K137476N06	1), 2)	K107482N50	K148329N50
		21943983	K079726N07	1), 2)		
		21931348	K090933N07	1), 2)		
		22169410	K096433N07	1), 2)		
		22169410	K096433_2N07	1), 2)		
		22242663	K099934N07	1), 2)		
		22358797	K107482N07	1), 2)		
22820097	K132982N07	1), 2)				
Renault	K, C & T Range - Euro 6		K137477N07	1), 2)	K099936N50	K148330N50
		7421578577	K026800N06	1), 3)		
		7422242650	K099936N06	1), 3)		
		7422820095	K132980N06	1), 3)		
		K137475N06	1), 3)			

1) With Heater

2) With Electronically Controlled Parking Brake

3) With Pneumatic Parking Brake

Note: the above mentioned cross-references to the Vehicle Manufacturer Part Nos. are provided only for the identification of the relevant IAM Part Nos. This information is provided without liability.

 - Compatible with NEO and KTS diagnostic platforms

€  - A core return surcharge will apply

EVERY VEHICLE TELLS ITS STORY.
KEEP IT RUNNING.

Up-to-date information on our products can be found on our website www.knorr-bremsecvs.com



Knorr-Bremse Group

Knorr-Bremse Systems for Commercial Vehicles
Moosacher Strasse 80 | 80809 Munich | Germany
Tel: +49 89 3547-0 | Fax: +49 89 3547-2767
WWW.KNORR-BREMSECVS.COM

Note

All information is subject to change. A printed version of this document may therefore not correspond to the latest revision. To obtain the latest version, please visit our website www.knorr-bremsecvs.com or contact a Knorr-Bremse representative in your area.

If service work is carried out on a vehicle based on information provided herein, it is the responsibility of the workshop to ensure the vehicle is fully tested and in full functional order before the vehicle is returned into service. Knorr-Bremse accepts no liability for problems caused as a result of appropriate tests not being carried out.

Copyright © Knorr-Bremse AG

All rights reserved, including industrial property rights applications. Knorr-Bremse AG retains any power of disposal, such as for copying and transferring.

Disclaimer

The information contained herein is intended for the exclusive use of trained persons within the commercial vehicle industry, and must not be passed on to any third party. All recommendations regarding products and their servicing or usage are with reference to Knorr-Bremse products and should not be considered applicable to products from other manufacturers. This information does not purport to be all-inclusive and no responsibility is assumed as a result of its use. We cannot accept any liability nor offer any guarantee regarding data accuracy, completeness or timeliness. The information does not represent any guarantee or ensured characteristics of the Products or Systems described. No liability can be accepted based on the information, its use, recommendations or advice provided. In no event may we be held liable for any damage or loss except in the case of wilful intent or gross negligence on our part, or if any mandatory legal provisions apply. This disclaimer is an English translation of a German text, which should be referred to for all legal purposes. Any legal disputes arising from the use of this information shall be subject to German law.